



HYNEK CHANGE LETTERS

HYNEKONOMY

WHOLESALE PRICE LIST *for* CANADA

205 NORSEMAN ST. TORONTO, ONT. M8Z 2R5

1-800-387-1902

FAX: (416) 232-2109 PHN: (416) 232-2827

Manufacturer's Confidential \$ CDN Wholesale Price List to the Sign Industry - September 2004

Hwy 401

Hwy 427	KIPING	BLOOR ST.	ISLINGTON
		NORSEMAN ST.	
		205	QEW

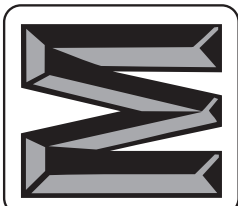

RIGID LETTERS

on .080" thick ACRYLIC.
3-D, SOLID

BLACK LETTERS
RED NUMBERS

STANDARD FONT SIZE	LETTER NAME	LETTER HEIGHT	PLASTIC HEIGHT	1-199	200-499	500-1999	2000+
200	4 INCH	4"	5"	.77	.73	.65	.63
212	6 INCH	6"	7"	1.10	1.02	.97	.88
216	8 INCH	8"	9-7/8"	1.44	1.30	1.27	1.18
236	10 INCH	10"	11-7/8"	2.07	1.97	1.86	1.71

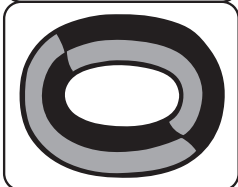

FLEX LETTERS

on .030" thick
FLEX PLASTIC.

BLACK LETTERS
RED NUMBERS

STANDARD FONT SIZE	LETTER NAME	LETTER HEIGHT	PLASTIC HEIGHT	Singles 1-99	Singles 100+	Fonts 1-4	Fonts 5+
306	2 INCH	1-1/2"	2"	.46	.35	33.50	32.34
273	4 INCH	3-1/2"	4-1/8"	.46	.35	56.60	54.29
300	7 INCH	6"	7"	.64	.46	114.35	108.57
300	9" Condensed	8"	8-7/8"	.69	.57	114.35	108.57
300	9" BOLD	8"	8-7/8"	.91	.68	125.90	120.12
300	11 INCH	10"	11"	1.10	.87	160.55	154.77

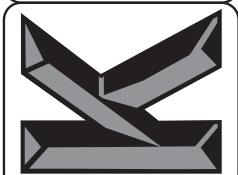
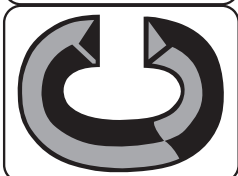

KOROFLO LETTERS

4 mil. COROPLAST.

PLAIN &
FLUORESCENT
COLORS

STANDARD FONT SIZE	LETTER NAME	LETTER HEIGHT	PLASTIC HEIGHT	1-499	500-999	1000+
228	5¼ INCH	4-1/4"	5-1/4"	.64	.58	.52
228	7 INCH	6-1/4"	7"	.92	.87	.81
228	10½ INCH	9-1/2"	10-1/2"	1.28	1.16	1.05
228	21 INCH	19"	21"	4.44	4.05	3.75

5¼" FL. YELLOW, FL. PINK, WHITE, PRIMROSE,
7" FL. YELLOW, FL. PINK, WHITE,
10½" FL. YELLOW, FL. PINK, WHITE, PRIMROSE, FL. ORANGE
21" FL. YELLOW, FL. PINK, WHITE, PRIMROSE,

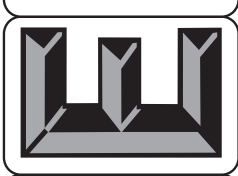

TRACK

TRACK NAME	TRACK LENGTH	1-9	10-19	20+
8' RIGID	8'	7.80	7.34	6.99
12' RIGID	12'	11.14	10.68	10.34
FLEX	7'7½"	7.04	6.70	6.36
COAK	8'	5.72	5.49	4.91
KOROFLO	7'8"	4.05	3.75	3.59

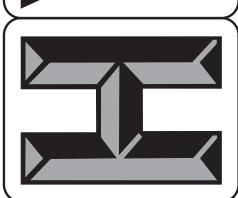
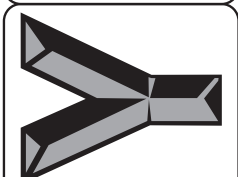

CHANGE POLES

POLE NAME	SUCTION CUP	1	2-4	5+
16 FEET	4"	91.25	86.63	79.70

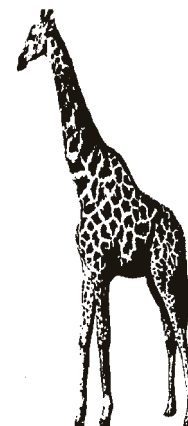

Get 'em at the sign of the High Neck!



ASK ABOUT OUR MANY SIGN PRODUCTS

Website - <http://www.hynek.com>

HYNEK

Signs LTD.

205 NORSEMAN ST.
TORONTO, CANADA M8Z 2R5
hyneksigns@aol.com

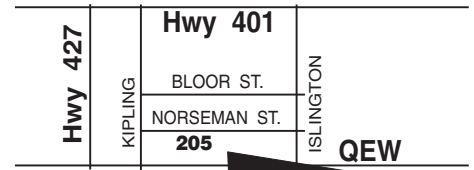

CALL: (416) **232-0900**

FAX: (416) **232-2109** **VISIT OUR SHOWROOM!**

SEPTEMBER 2004

18" X 24" VINYL BAG SIGNS

SUGGESTED CANADIAN RETAIL & WHOLESALE PRICES (INCLUDING WIRE STANDS)

QUANT.	1 col./2 sides	2 col./2 sides	3 col./2 sides
50	\$6.60 \$5.06	\$8.53 \$6.55	\$10.45 \$8.03
100	\$5.50 \$4.24	\$7.15 \$5.50	\$8.80 \$6.77
200	\$4.95 \$3.80	\$6.44 \$4.95	\$7.92 \$6.11
300	\$4.40 \$3.41	\$5.72 \$4.40	\$7.04 \$5.39
500+	\$3.85 \$2.97	\$5.06 \$3.91	\$6.27 \$4.84

Price includes artwork under 1/2 hr., set up, printing both sides and wire frames.

COLOURS AVAILABLE & PANTONE EQUIVALENTS:

-Brilliant Red - 485C 2X	-Lemon Yellow - YELLOWC 2X	-Reflex Blue - REFLEX BLUEC	-Maroon - 202C
-Fire Red - 185C 2X	-Forest Green - 327C 2X	-Brilliant Blue - 2748 C	-Purple - VIOLETC
-Orange - 021C	-Emerald Green - 354C	-Process Blue - PROCESS BLUEC 2X	-Brown - 168C
-Medium Yellow - 123C	-Royal Blue - REFLEX BLUE 2X	-Peacock Blue - 299C 2X	-Black - BLACK



HYNEK CHANGE LETTERS

HYNEKONOMY

WHOLESALE PRICE LIST for CANADA

205 NORSEMAN ST. TORONTO, ONT. M8Z 2R5

1-800-387-1902

FAX: (416) 232-2109 PHN: (416) 232-2827

Manufacturer's Confidential \$ CDN Wholesale Price List to the Sign Industry - September 2004

Hwy 401

Hwy 427

KIPLING

BLOOR ST.

NORSEMAN ST.

205

ISLINGTON

QEW



SPECIAL ITEMS:

These items are stocked in smaller quantities. Please allow time for order completion if necessary. **NO EXCHANGE OR REFUND ON THESE ITEMS!**

SPECIAL RIGID LETTERS

on .080" thick ACRYLIC.

LETTER NAME	Letter Height	Plastic Height	Letter Color	Number Color	1-199	200-499	500+
4" 3-D/SOLID	4"	5"	RED	BLACK	.76	.71	.65
4" 3-D (Only)	4"	5"	BLUE	BLUE	.87	.82	.76
6" 3-D/SOLID	6"	7"	RED	BLACK	1.09	1.04	.98
6" SOLID (Only)	6"	7"	Blue/White	Blue/White	1.31	1.26	1.20
7" SOLID (Only)	7"	7-7/8"	BLACK	Black/Red	1.19	1.07	1.04
8" 3-D/SOLID	8"	9-7/8"	RED	BLACK	1.42	1.31	1.20
8" SOLID (Only)	8"	9-7/8"	Blue/White	Blue/White	1.53	1.42	1.31
10" 3-D/SOLID	10"	11-7/8"	RED	BLACK	1.97	1.86	1.75
12" 3-D	12"	14-7/8"		Black/Red	3.48	3.24	3.13
12" SOLID	12"	14-7/8"	BLACK	BLACK	3.48	3.24	3.13
15" SOLID	15"	17"		Black/Red	5.51	5.24	4.97
16-1/2" SOLID	16-1/2"	19-1/4"		Black/Red	9.61	9.35	9.03
4-3/8" REVERSE	4-3/8"	5-3/8"	CLEAR CHARACTER BLACK BACKGROUND		1.10	1.05	.93
6" Reverse (Bevelled Edges)	6"	7"	CLEAR CHARACTER BLACK BACKGROUND		1.38	1.32	1.27
8" Reverse (With Clips)	8"	9-7/8"	CLEAR CHARACTER BLACK BACKGROUND		1.93	1.82	1.76
10" REVERSE	10" <small>Constant Width 6-13/16"</small>	11-7/8"	CLEAR-WHITE-YELLOW BLACK BACKGROUND		2.48	2.42	2.37

SPECIAL FLEX LETTERS

on .030" thick FLEX PLASTIC.

LETTER NAME	Letter Height	Plastic Height	Letter Color	Number Color	1-199	200-499	500+
7" FLEX	6"	7"	RED		.58	.53	.47
7" FLEX	6"	7"	WHITE	WHITE	.63	.58	.53
9" FLEX BOLD	8"	8-7/8"	RED & WHITE		.89	.84	.79
9" BOLD Fluorescent <small>WARNING - Fluorescent Fades!</small>	8"	8-7/8"	RED & YELLOW		.89	.84	.79
9" FLEX Z-P	8"	8-7/8"	BLUE	RED	.89	.84	.79
18" FLEX	16"	18-1/8"	RED	RED	3.10	2.89	2.68

STATIC KLINGON LETTERS

LETTER NAME	Letter Height	Sheet Size	Letter	Color	1-9 Sheets	10-24 Sheets	25+ Sheets
4" Klingon Fluorescent <small>WARNING - Fluorescent Fades!</small>	4"	25" x 38"	Red-Yellow-Green		8.87	8.35	8.14
8" Klingon Fluorescent <small>WARNING - Fluorescent Fades!</small>	8"	25" x 38"	Red-Yellow-Green		8.87	8.35	8.14

CHANGE BANNER LETTERS

LETTER NAME	Letter Height	Plastic Height	Letter Color	Number Color	1-199	200-499	500+
4"x9" 2-SIDED	8-1/4"	9"	VARIOUS*		.79	.74	.68
7"x11" 2-SIDED	10"	11"	VARIOUS*		1.05	1.00	.95

*4"x9"> BLACK/YELLOW-RED/WHITE, BLUE/WHITE-RED/WHITE, BLUE/WHITE-WHITE/RED
*7"x11"> BLACK/YELLOW-RED/WHITE, BLUE/WHITE-RED/WHITE, BLUE/WHITE-WHITE/RED
BLACK/FL. PINK-BLACK/FL. YELLOW

CHANGE POLE Accessories

ACCESSORY NAME	1+
4" SUCTION CUP	16.80
HARDWARE ONLY (Neck)	29.40
4" Suction Cup & Hardware	46.20

Visit
HYNEK.COM

www.
BAG-SIGN.com
1-866-BAGSIGN

STANDARD LETTER ORDER FORM

DATE: _____

COMPANY NAME: _____ P.O.: _____

ADDRESS: _____ CITY: _____ PRV: _____ ZIP: _____

CONTACT: _____ PHONE #: _____

SOLID RIGID <input type="checkbox"/>	<input type="checkbox"/> 4" on 5"	<input type="checkbox"/> 6" on 7"	<input type="checkbox"/> 8" on 9-7/8"	<input type="checkbox"/> 10" on 11-7/8"	<input type="checkbox"/> 12" on 14-7/8"	<input type="checkbox"/> 16.5" on 19.25"
3-D RIGID <input type="checkbox"/>	<input type="checkbox"/> 4" on 5"	<input type="checkbox"/> 6" on 7"	<input type="checkbox"/> 8" on 9-7/8"	<input type="checkbox"/> 10" on 11-7/8"	<input type="checkbox"/> 12" on 14-7/8"	<input type="checkbox"/> 16.5" on 19.25"
FLEX <input type="checkbox"/>	<input type="checkbox"/> 1.5" on 2"	<input type="checkbox"/> 3.5" on 4.125"	<input type="checkbox"/> 6" on 7"	<input type="checkbox"/> 8" on 8-7/8" BOLD	<input type="checkbox"/> 8" on 8-7/8" COND.	<input type="checkbox"/> 10" on 11"
KOROFLO <input type="checkbox"/>	<input type="checkbox"/> 4.25" on 5.25"	<input type="checkbox"/> 6.25" ON 7"	<input type="checkbox"/> 9.5" on 10.5"	<input type="checkbox"/> 19" ON 21"		

RIGID STANDARD FONT KIT : 4" RIGID = 200, 6" RIGID = 212, 8" RIGID = 216, 10" RIGID = 236 **KOROFLO STANDARD FONT KIT :** ALL SIZES = 228

FLEX STANDARD FONT KIT : 2" FLEX = 306, 4" FLEX = 273, 6" FLEX = 300, 8" FLEX BOLD = 300, 8" FLEX CONDENSED = 300, 11" FLEX = 300

FONT SIZE:

STANDARD <input type="checkbox"/>	100 <input type="checkbox"/>	150 <input type="checkbox"/>	200 <input type="checkbox"/>	212 <input type="checkbox"/>	216 <input type="checkbox"/>	228 <input type="checkbox"/>	236 <input type="checkbox"/>	250 <input type="checkbox"/>	300 <input type="checkbox"/>	350 <input type="checkbox"/>	400 <input type="checkbox"/>	500 <input type="checkbox"/>	600 <input type="checkbox"/>
-----------------------------------	------------------------------	------------------------------	------------------------------	------------------------------	------------------------------	------------------------------	------------------------------	------------------------------	------------------------------	------------------------------	------------------------------	------------------------------	------------------------------

INDIVIDUAL LETTERS & NUMERS:

COLOUR: _____

A	B	C	D	E	F	G	H	I	J	K	L	M
N	O	P	Q	R	S	T	U	V	W	X	Y	Z
!	&	.	-	,	:	?	"					

COLOUR: _____ **TOTAL:** _____

1	2	3	4	5	6	7	8	9	0
¢	\$	%	.	-					

TOTAL: _____

TRACK

QTY. <input type="checkbox"/>	RIGID 8' <input type="checkbox"/>	FLEX 7'-7.5" <input type="checkbox"/>	KOROFLO 7'-8" <input type="checkbox"/>	COAK 8' <input type="checkbox"/>
-------------------------------	-----------------------------------	---------------------------------------	--	----------------------------------

CHANGE POLE

QTY. <input type="checkbox"/>	COMPLETE <input type="checkbox"/>	4" SUCTION CUP <input type="checkbox"/>	HARDWARE ONLY <input type="checkbox"/>	HARDWARE & 4" SUCTION CUP <input type="checkbox"/>
-------------------------------	-----------------------------------	---	--	--

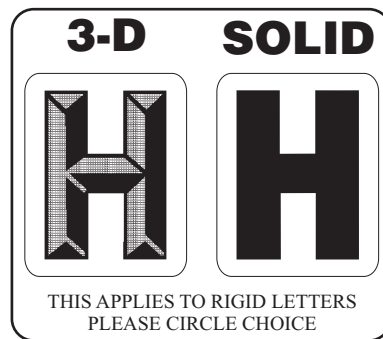

NOTES FOR YOUR ADDITIONAL INFORMATION

PLEASE FAX THIS ORDER FORM TO 416-232-2109

CREDIT CARD #: _____ **EXPIRY DATE:** _____ **CARD HOLDER:** _____

FOR OTHER PRODUCTS NOT LISTED ON THIS FORM PLEASE CONTACT US @ 1-800-387-1902

Rigid on .080 Thick Acrylic

Standard Fonts: 4" 6" 8" 10"

	100	150	200	212	216	236	250	300	350	400	500	600
A	4	8	10	8	10	12	12	12	18	20	24	24
B	3	4	6	4	6	6	6	8	10	8	12	16
C	3	4	6	6	6	6	6	8	10	12	12	16
D	3	4	6	4	6	6	6	8	10	8	12	16
E	7	10	12	8	10	12	16	18	22	20	32	36
F	3	4	6	6	6	8	6	8	10	8	12	16
G	3	4	6	4	6	8	6	8	10	8	12	16
H	3	4	6	6	6	6	6	6	10	8	12	12
I	6	10	12	6	10	12	12	16	22	24	24	32
J	2	2	4	4	2	2	4	6	6	4	8	12
K	3	4	6	4	6	6	6	8	10	8	12	16
L	3	6	8	8	6	8	10	10	14	12	20	20
M	3	6	8	6	6	8	8	8	14	12	16	16
N	3	6	8	8	8	8	8	10	14	12	16	20
O	4	8	10	8	8	10	12	12	18	20	24	24
P	3	6	8	6	8	8	8	10	14	8	16	20
Q	2	2	2	2	2	2	4	4	4	4	8	8
R	3	6	8	8	8	8	8	10	14	12	16	20
S	3	6	8	8	8	8	8	10	14	12	16	20
T	3	6	8	8	8	8	8	10	14	12	16	20
U	3	8	10	6	8	10	10	12	18	12	20	24
V	2	2	4	4	2	2	6	6	6	4	12	12
W	2	2	4	4	2	2	6	6	6	4	12	12
X	2	2	2	2	2	2	4	4	4	4	8	8
Y	2	2	4	6	6	8	4	6	8	8	8	12
Z	2	2	2	2	2	2	4	4	4	4	8	8
!				4	2	2						
&			2	2	2	2	2	2	2	4	4	4
.					2	2				4		
,												
'												
?												
/												
¢			2	4	2	2	4	2	2	8	8	4
\$		2	2	4	2	2	4	4	2	8	8	8
%				4	2	2	2			8	4	
.				4	2	2	4	4		8	8	8
:				4	2	2				8		
>												
*												
1	2	2	2	4	4	4	4	6	4	8	8	12
2	2	2	2	4	4	4	4	6	4	8	8	12
3	2	2	2	4	4	4	4	6	4	8	8	12
4	2	2	2	4	4	4	4	6	4	8	8	12
5	2	2	2	4	4	4	4	6	4	8	8	12
6	2	2	2	4	5	5	4	6	4	8	8	12
7	2	2	2	4	4	4	4	6	4	8	8	12
8	2	2	2	4	4	4	4	6	4	8	8	12
9	2	2	2	4	5	5	4	6	4	8	8	12
0	2	2	2	4	4	4	4	6	4	8	8	12
	100	150	200	212	216	236	250	300	350	400	500	600

THE ABOVE ARE BLACK IN COLOUR & THE BELOW CHARACTERS ARE RED IN COLOUR

Flex on .030 Thick Acrylic

2" 4" 7" 9" 9" 11"
BOLD CNSD

	306	273	300	300	300	300
A	12	12	17	20	12	11
B	6	6	6	8	6	6
C	12	9	8	8	6	11
D	6	6	6	8	6	6
E	12	12	17	16	12	11
F	6	6	6	8	6	6
G	6	6	6	8	6	6
H	6	6	6	8	6	6
I	12	12	17	20	12	22
J	6	3	4	2	6	6
K	6	6	6	8	6	6
L	12	9	8	12	12	11
M	6	6	6	6	6	6
N	12	9	8	8	6	6
O	12	9	17	12	12	11
P	6	9	8	8	6	11
Q	6	3	4	2	6	6
R	12	9	8	12	12	11
S	12	9	8	12	12	11
T	12	9	8	12	6	11
U	6	9	8	8	6	11
V	6	6	4	4	6	6
W	6	6	3	2	2	5
X	6	3	4	2	6	6
Y	6	6	10	8	6	6
Z	6	3	4	2	6	6
!	6	3	3	4	4	6
&	6	3	3	4		6
.	6	3	3	2	6	6
,			3	4		
'			4	2		
?			4	2		
/						
¢					3	
\$	3	3	2	2	3	4
%	3	3	2	2	3	4
.	3	3	2	2	3	
:		3		4	3	6
>	3			2	3	
*			4			
1	6	6	11	8	15	8
2	6	6	6	4	6	4
3	6	6	6	4	6	4
4	6	6	6	4	6	4
5	6	6	8	4	6	4
6	6	6	4	4	6	4
7	6	6	4	4	6	4
8	6	6	4	4	6	4
9	6	6	8	4	9	4
0	6	6	4	4	6	4
	306	273	300	300	300	300

 **HYRNEK CHANGE LETTERS**
205 NORSEMAN ST. TORONTO, ONTARIO M8Z 2R5
1-800-387-1902

FONT LIST